

# FT2267/2



## THREADED CARTRIDGE MOUNTED DOUBLE-ACTING CONTROL VALVES

They allow for regulation of flow in both directions.

### On request

- Knob in ABS (mp)

## dimensions

| Type | A UNI4534 | ØB | C    | D    | E    | ØF | ØF1 | G    | H     | L    | CH | Weight kg |
|------|-----------|----|------|------|------|----|-----|------|-------|------|----|-----------|
| 18   | M15x1     | 12 | 9,3  | 11,2 | 20,5 | 22 | 40  | 35   | 55,5  | 5    | 22 | 0,064     |
| 14   | M20x1,5   | 14 | 11   | 15,5 | 26,5 | 27 | 50  | 42,5 | 68,5  | 7    | 27 | 0,125     |
| 38   | M20x1,5   | 16 | 13   | 17,5 | 30,5 | 33 | 70  | 48,5 | 78,5  | 9    | 27 | 0,180     |
| 12   | M27x2     | 19 | 15,5 | 24,5 | 40   | 38 | 80  | 56   | 96    | 10,5 | 32 | 0,305     |
| 34   | M33x2     | 27 | 18   | 26   | 44   | 47 | 100 | 63,5 | 109   | 13   | 41 | 0,580     |
| 100  | M42x2     | 35 | 22   | 30,5 | 52,5 | 58 | 120 | 82   | 134,5 | 20   | 50 | 1,185     |
| 112  | M52x2     | 45 | 31,5 | 33   | 64,5 | 58 | 120 | 85   | 148   | 25   | 60 | 1,6       |

## materials

|                    |                          |
|--------------------|--------------------------|
| Body               | AISI 316 stainless steel |
| Needle             | AISI 316 stainless steel |
| OR                 | Viton                    |
| Antiextrusion ring | PTFE                     |
| Handwheel          | GD Al Si 12 - UNI 5706   |
| Handwheel (mp)     | ABS                      |

## example for ordering

| Code      | Type | Plastic handwheel |
|-----------|------|-------------------|
| FT 2267/2 | 12   | mp                |

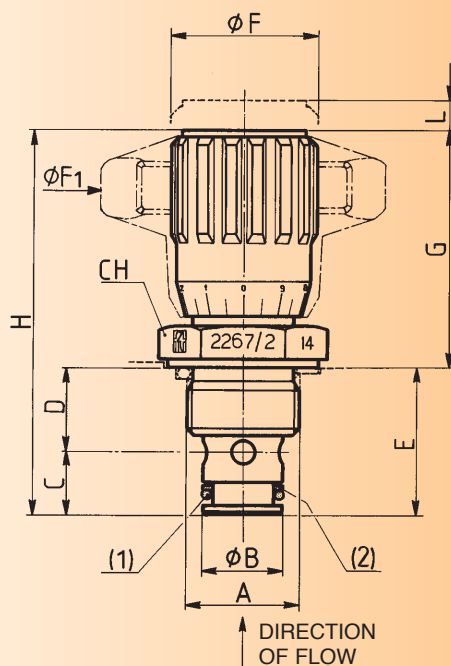

## technical data

| Type | Port section<br>sq. cm | Max. working<br>pressure bar | Min. burst.<br>pressure bar | Working<br>temp. °C | Filtrazion grade<br>µm |
|------|------------------------|------------------------------|-----------------------------|---------------------|------------------------|
| 18   | 0,12                   | 320                          | 1300                        | -20° / +130 °C      | 25                     |
| 14   | 0,19                   | 320                          | 1300                        | -20° / +130 °C      | 25                     |
| 38   | 0,39                   | 320                          | 1300                        | -20° / +130 °C      | 25                     |
| 12   | 0,68                   | 320                          | 1300                        | -20° / +130 °C      | 25                     |
| 34   | 1,13                   | 320                          | 1300                        | -20° / +130 °C      | 25                     |
| 100  | 2,09                   | 320                          | 1300                        | -20° / +130 °C      | 25                     |
| 112  | 3,14                   | 320                          | 1300                        | -20° / +130 °C      | 25                     |

## kit of seals for seat

| Tipo | OR   | BK   |
|------|------|------|
| 18   | 2018 | 2018 |
| 14   | 2021 | 2021 |
| 38   | 108  | 108  |
| 12   | 2043 | 2043 |
| 34   | 115  | 115  |
| 100  | 123  | 123  |
| 112  | 128  | 128  |

## kit of seals for needle

| Tipo | 1(OR) | 2(BK)                  |
|------|-------|------------------------|
| 18   | 108   | FT 2267/2-022.00.1-18  |
| 14   | 2043  | FT 2267/2-022.00.1-14  |
| 38   | 2050  | FT 2267/2-022.00.1-38  |
| 12   | 2062  | FT 2267/2-022.00.1-12  |
| 34   | 130   | FT 2267/2-022.00.1-34  |
| 100  | 3118  | FT 2267/5-022.00.1-34  |
| 112  | 4187  | FT 2267/5-022.00.1-100 |

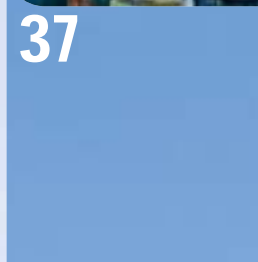
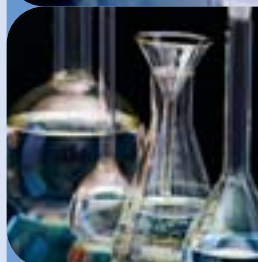

# flowrate



FT 2267/2 - 18

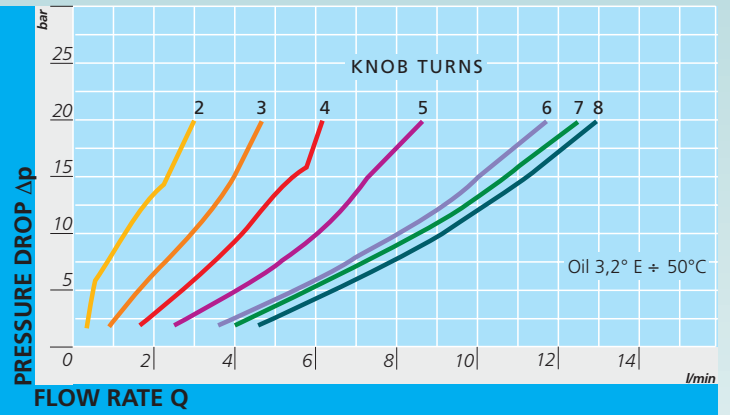

FT 2267/2 - 14

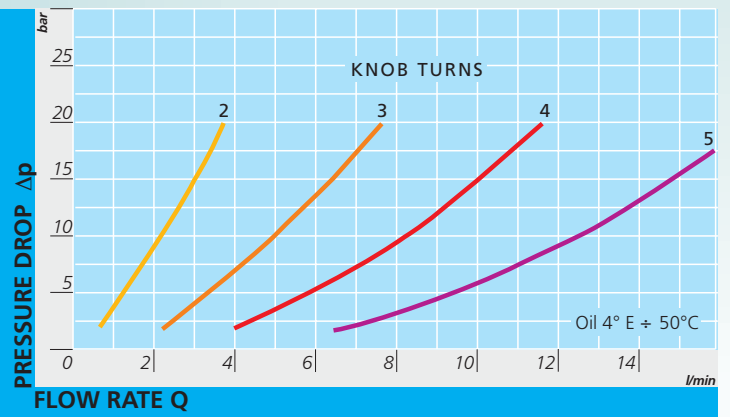

FT 2267/2 - 38

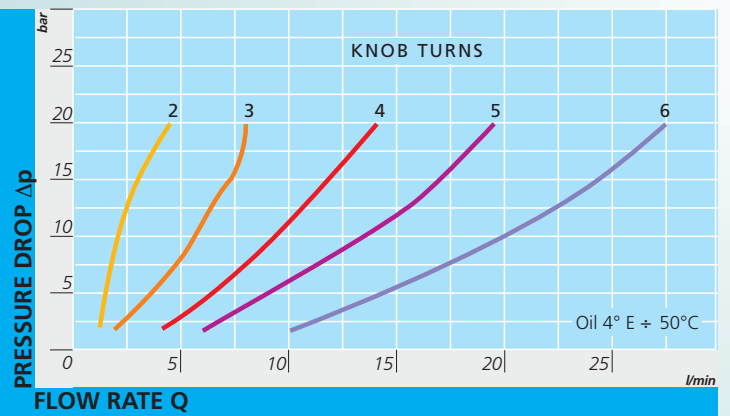

# curves

FT 267/2 - 12

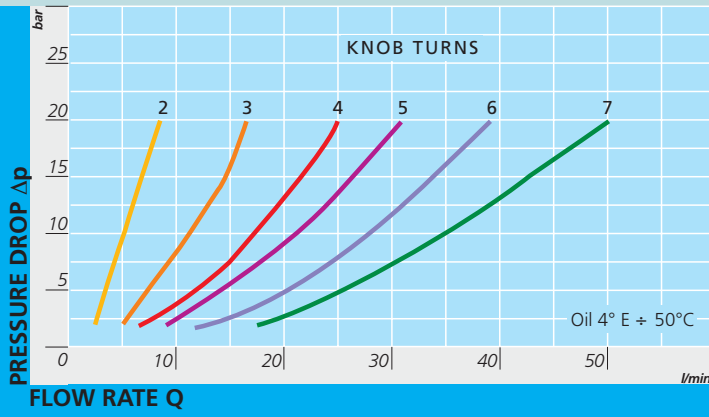

FT 2267/2 - 34

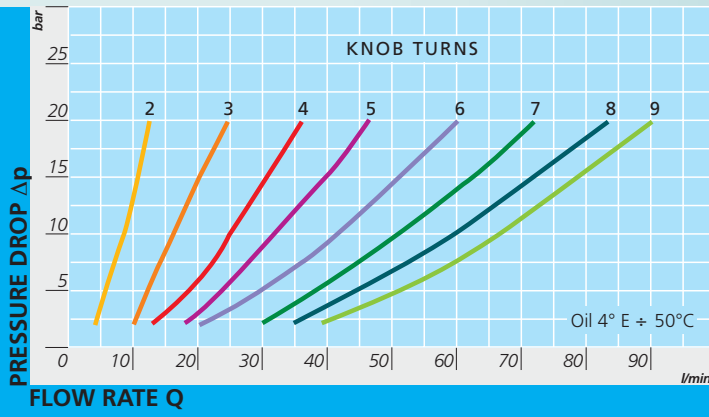

FT 2267/2 - 100

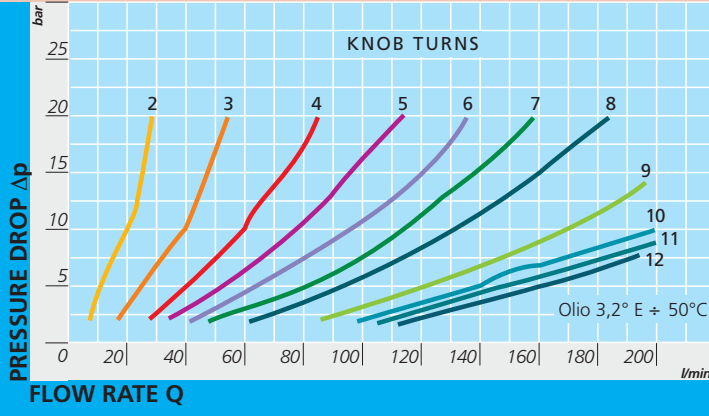

FT 2267/2-112

