

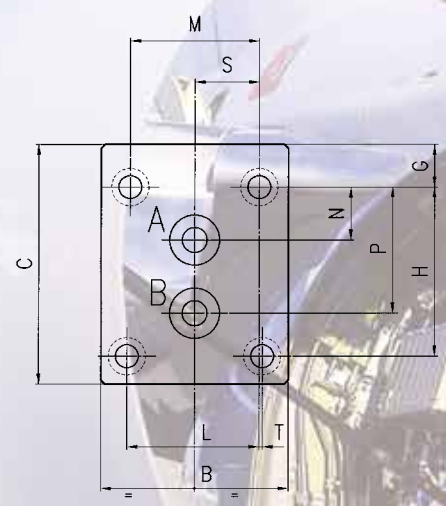
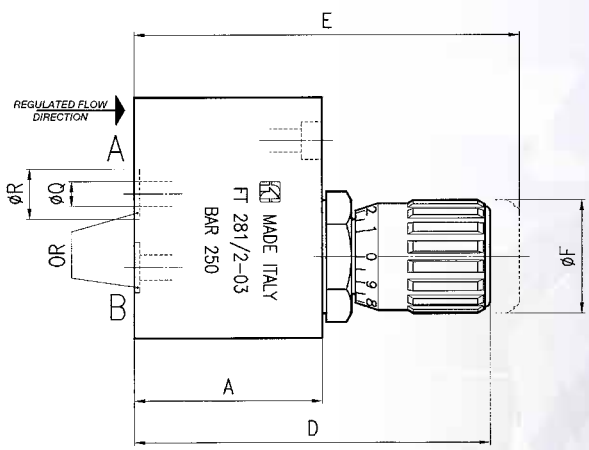

MATERIALS

TERMINAL STRIP	11 S MN Pb 30 - UNI EN 10087
CARTRIDGE BODY	11 S MN Pb 30 - UNI EN 10087
NEEDLE	AISI 303 - UNI EN 10088
HANDWHEEL	GD AL SI 12 UNI EN AB 46100
NIPPLE	NYLON 6
OR	NITRILE
ANTIEXTRUSION RINGS	PTFE
<i>All components are surface treated and protected</i>	

DIMENSIONS

TYPE	A	B	C	D	E	∅F	G	H	L
03	32	45	52	66	74	22	5,75	40,5	31,75
60	32	45	52	66	74	22	5,75	40,5	31,75

DIMENSIONS

TYPE	M	N	P	∅Q	∅R	S	T	OR	SCREW	WEIGHT KG
03	31	12,7	30,2	5	12	15,5	0,75	108	M5x40	0,570
60	31	10	33	5	17,2	15,5	0,75	2056	M5x40	0,570

EXAMPLE FOR ORDERING

CODE	TYPE
FT 281/2	60

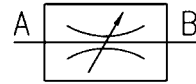

DOUBLE-ACTING MICROFINE CONTROL PLATE VALVES

They are the most suitable solution for those applications requiring precise adjustment characteristics or for reduced rate of flow. They are provided with plate connections mod. CETOP 03 or interchangeable with the broadly used valves. The connection seals are equipped in series. Max. working pressure 250 bar.



FT 281/2

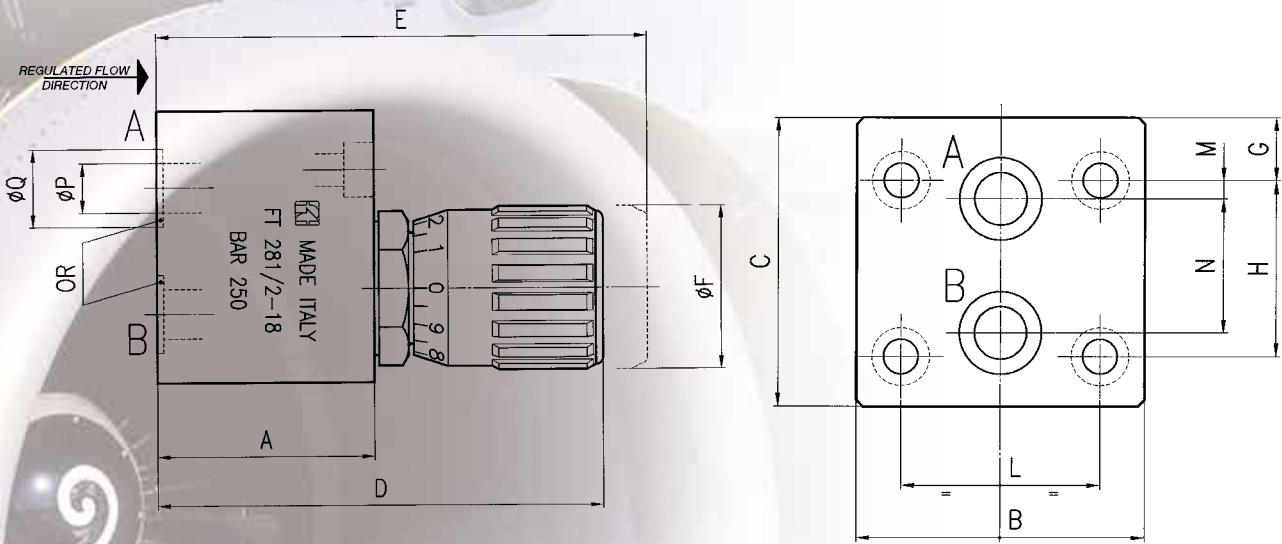

DIMENSIONS

TYPE	A	B	C	D	E	ØF	G	H	L	M	N	ØP	ØQ	OR	SCREW	WEIGHT KG
18	32	42	35	66	74	22	8	19	28,5	1,5	16	4	9,5	2025	M6x40	0,350

EXAMPLE FOR ORDERING

CODE	TYPE
FT 281/2	18

